

4350 BAFFLE DETAIL #1

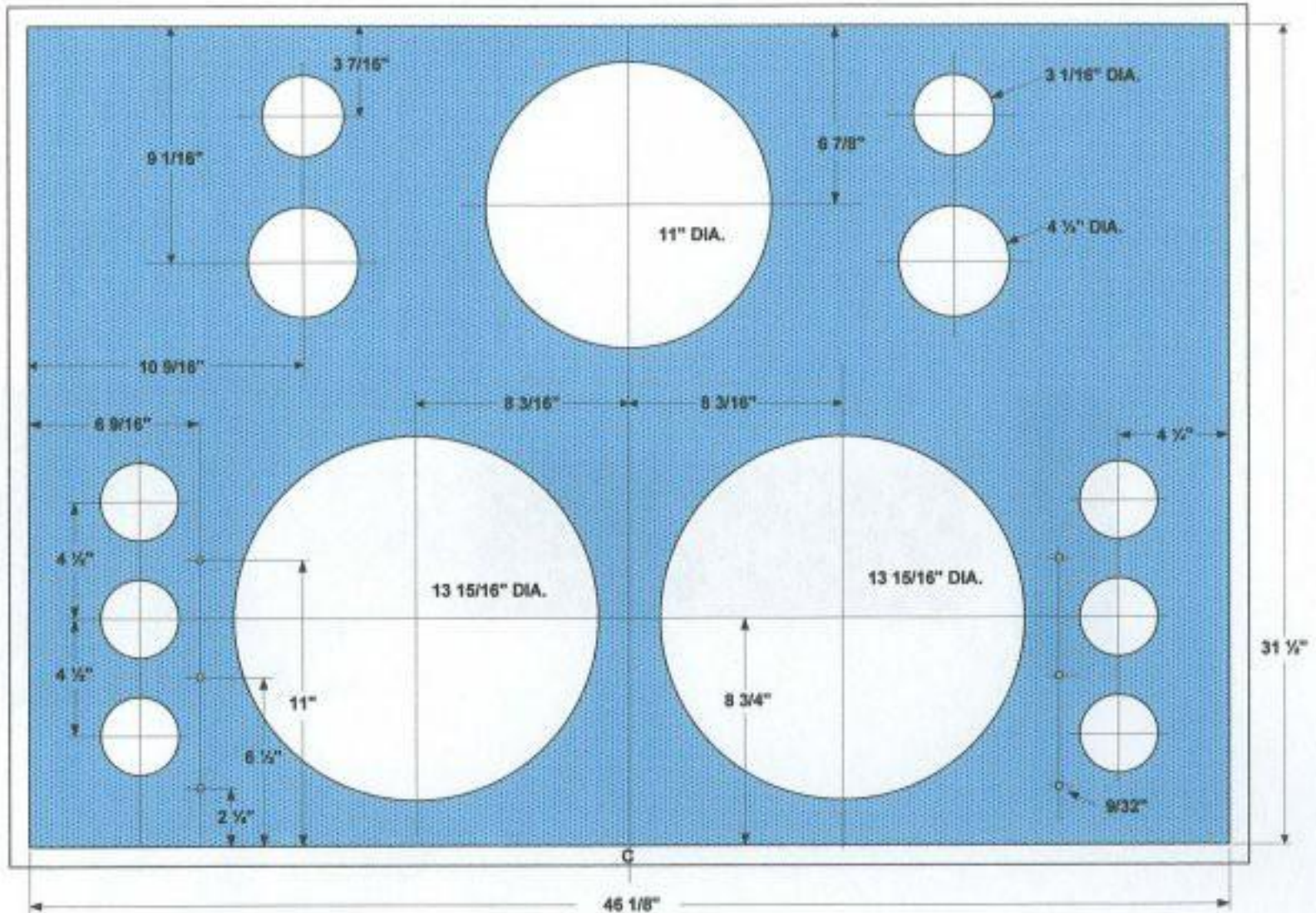

THE BAFFLE LAYOUT AND LOCATION OF ALL HOLES IS ESSENTIALLY THE SAME FOR ALL MODELS, EARLY TO LATE, INCLUDING THE 4350B. EXACT LOCATION OF EACH CUTOUT MAY VARY 1/16" FROM CABINET TO CABINET. THIS STATEMENT IS BASED ON MY OBSERVATIONS OF 6 TO 8 PAIRS OF ORIGINAL CABINETS.

4350 BAFFLE DETAIL #2

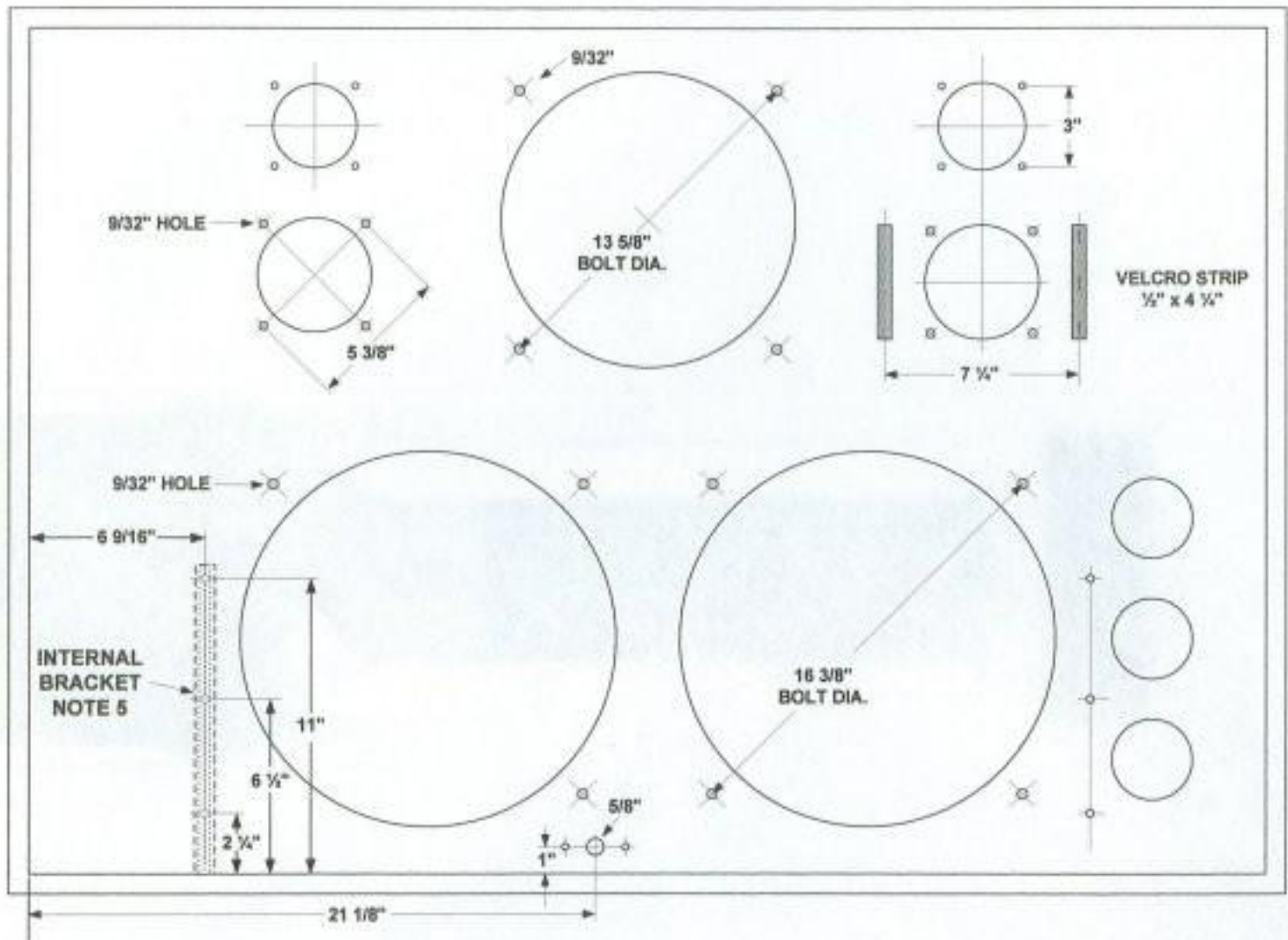

4350 BAFFLE DETAIL #3

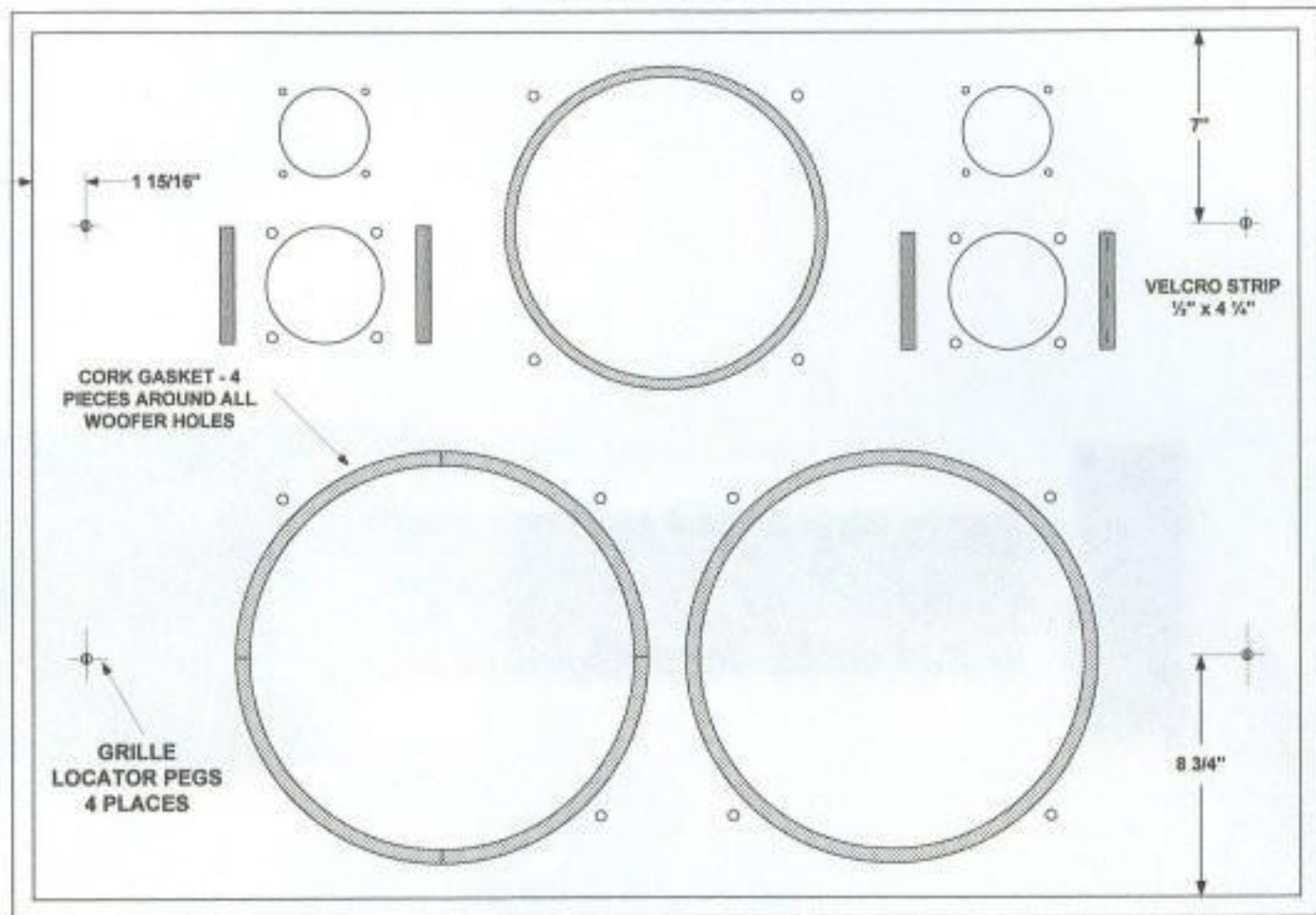

4350 BAFFLE DETAIL #4
GRILLE MOUNT VELCRO TABS

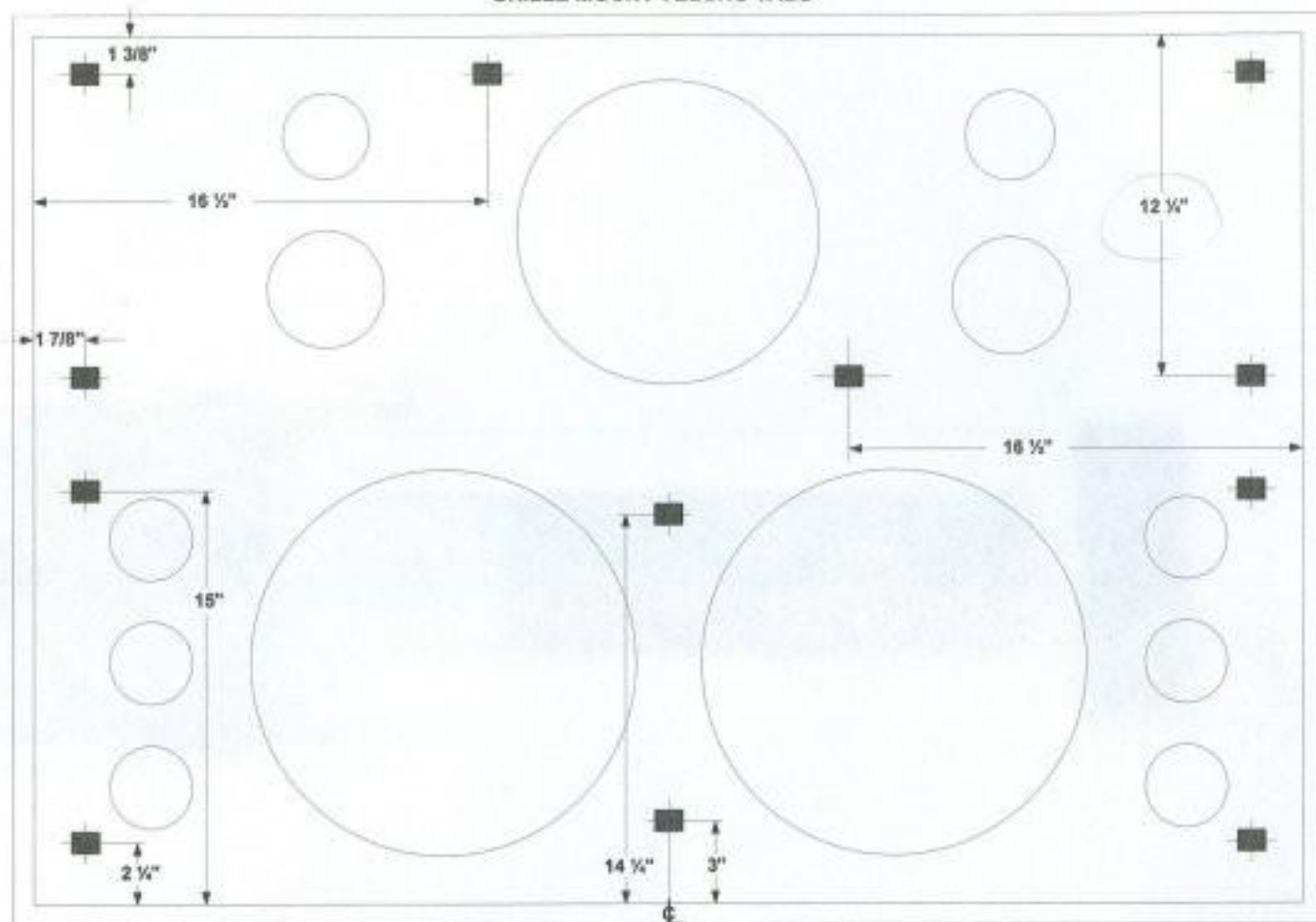

VELCRO TABS ARE 1/4" HIGH X 1" WIDE WITH SELF ADHESIVE
PEEL AND STICK BACKING. EACH TAB IS STAPLED IN TWO
PLACES WITH 1/8" CROWN WIRE STAPLES.

4350 BAFFLE - EARLY MODEL

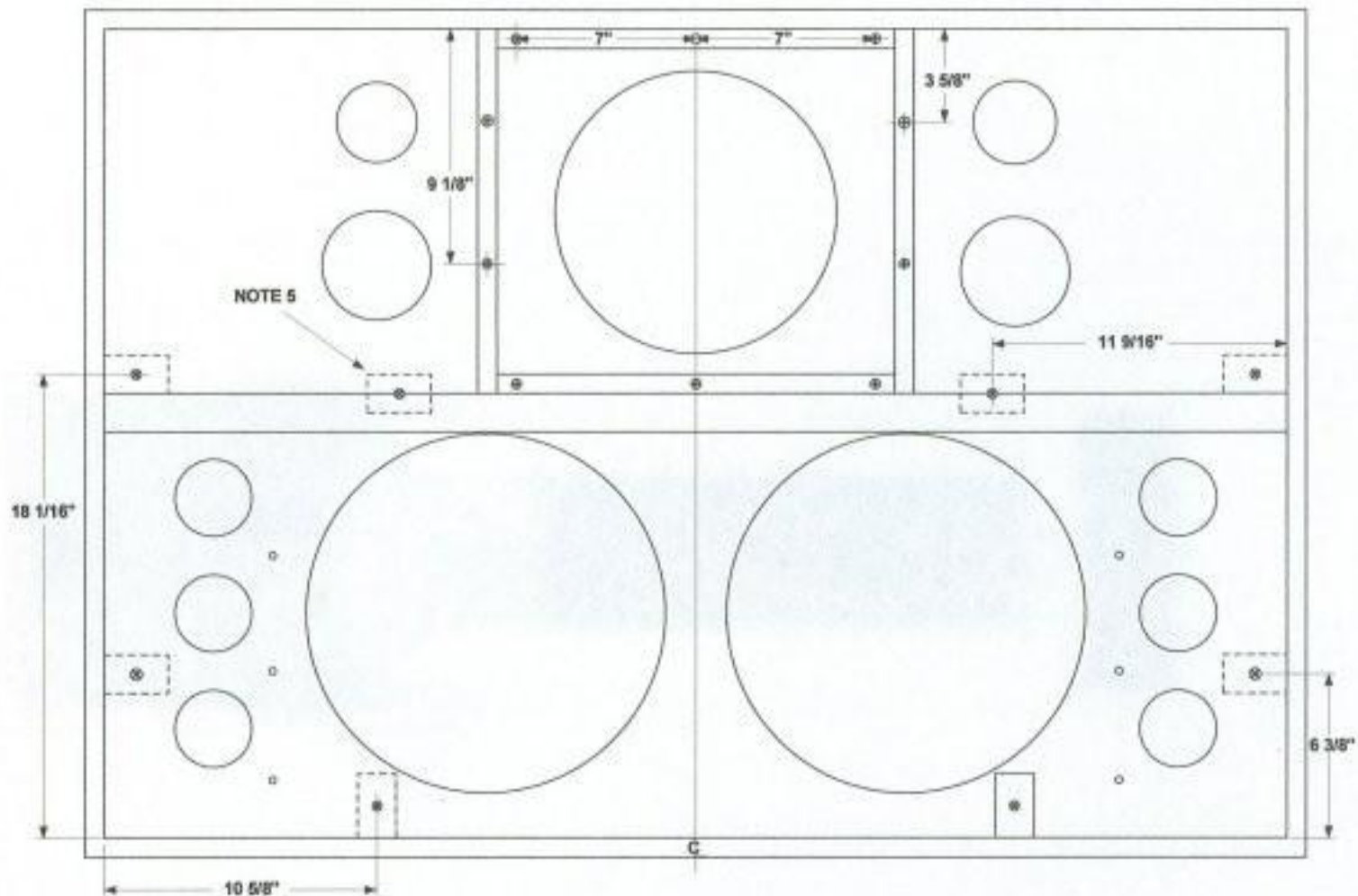

EARLY MODELS HAD ALL BRACES SCREWED FROM THE OUTSIDE -
BAFFLE AND BACK. SCREW HEADS ARE VISIBLE ON THE BAFFLE
AND BACK. SCREWS USED WERE #8 2" PHILLIPS HEAD

4350 CABINET BRACING #1

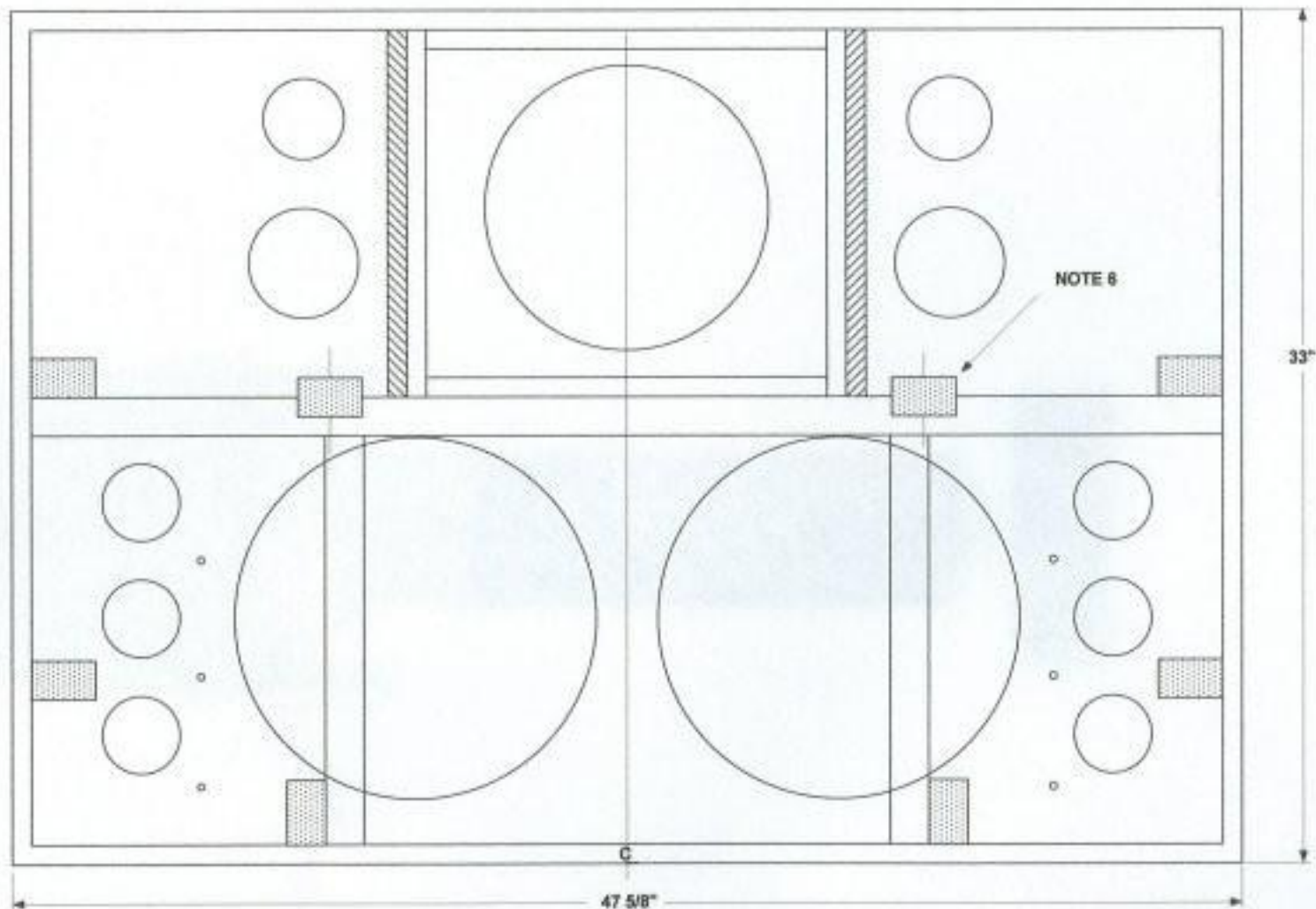

ALL INTERNAL CABINET BRACES ARE 1 1/2" x 2 1/2". FACTORY CABINETS USED INEXPENSIVE PINE. FIR OR POPLAR WOULD BE BETTER CHOICES. ALL BRACES ARE GLUED AND SCREWED TO THEIR RESPECTIVE PANELS PRIOR TO CABINET ASSEMBLY. ON SOME CABINETS, THAT APPEAR TO BE MID TO LATE PRODUCTION (4350'S), THE BACK BRACES WERE GLUED AND NAILED FROM THE OUTSIDE. THE NAIL HEADS ARE VISIBLE THROUGH THE BLACK PAINT ON THE CABINET BACK.

NOTE 6 THE PURPOSE OF THIS BRACE IS TO PROVIDE SUPPORT FOR THE 2440 DRIVER WITH FACTORY INCLUDED METAL BRACKET. THIS BRACE WAS NOT USED ON THE VERY EARLY MODELS.

4350 CABINET BRACING #2

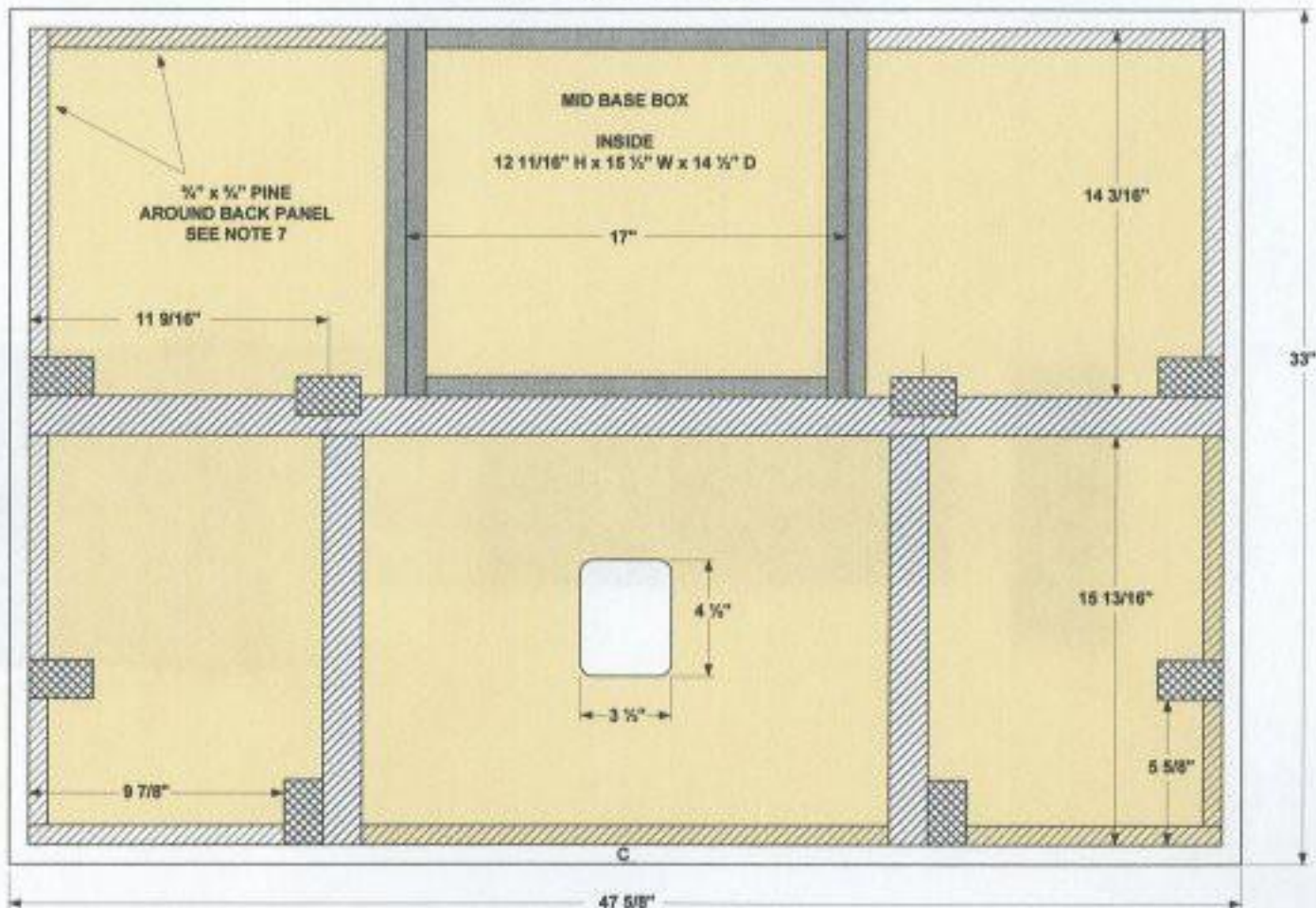

NOTE 7

ALL 4350'S THAT I HAVE SEEN, FROM THE VERY EARLY MODELS THRU LATE 4350'S WITH ALNICO COMPONENTS, HAVE HAD A $1/4" \times 1/2"$ PINE STRIP AROUND THE BACK PANEL. IT IS GLUED AND STAPLED TO THE BACK PANEL AND ADJACENT PANEL SURFACE. ALL CABINET BRACES THAT INTERSECT THIS STRIP ARE NOTCHED OUT $7/8" \times 7/8"$ TO CLEAR THE STRIP. I HAVE OBSERVED TWO PAIRS OF 4350B'S THAT DO NOT HAVE THIS BORDER STRIP.

4350 CABINET BRACING #3 - CABINET REAR VIEW

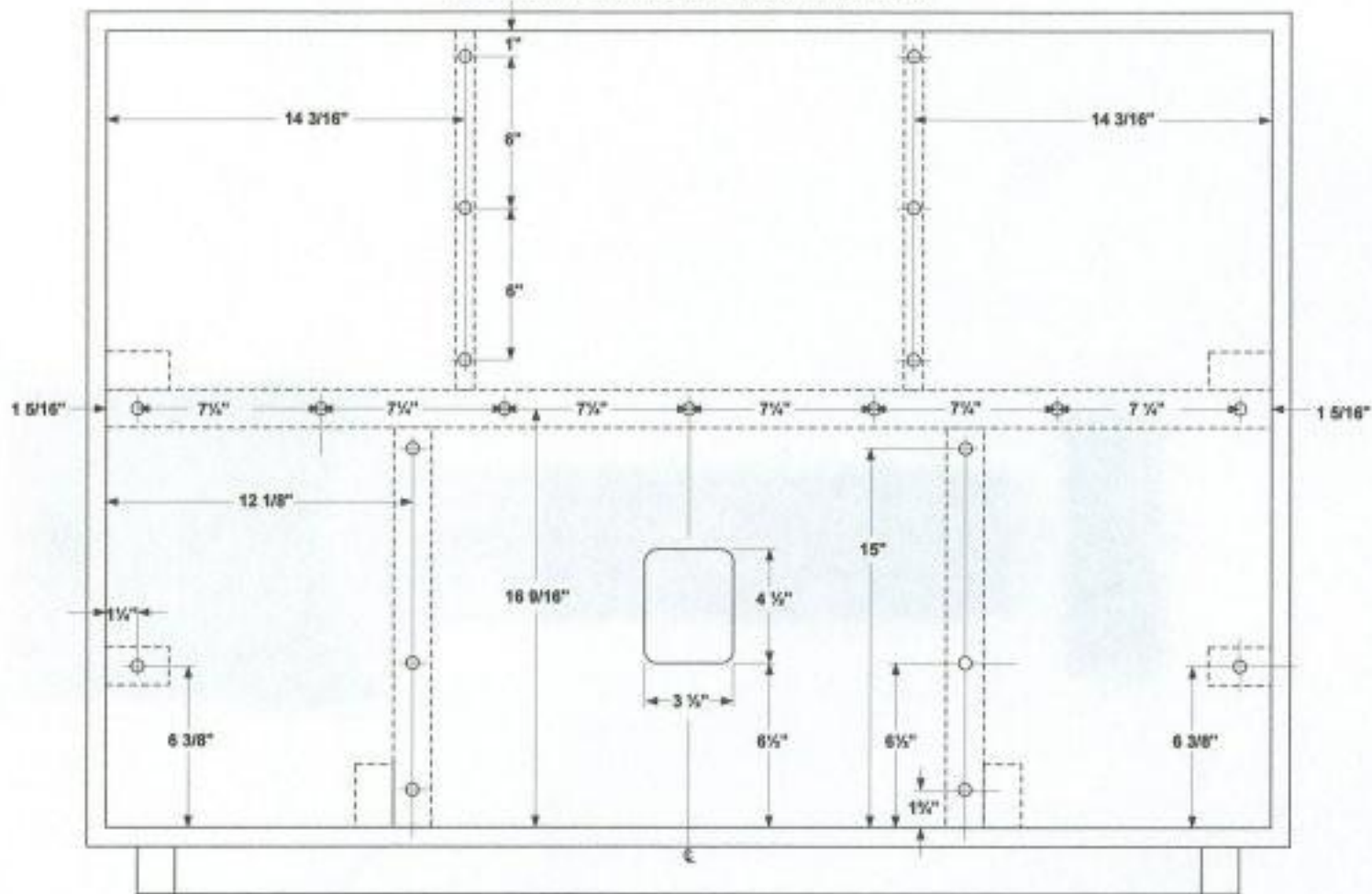

VERY EARLY 4350'S HAD THE BACK BRACING SCREWED FROM THE OUTSIDE, THRU THE BACK AND INTO THE BRACE. ON THOSE MODELS THE PHILLIPS HEAD SCREWS ARE VISIBLE ON THE BACK. LATER MODELS HAD THE BRACES SCREWED FROM THE INSIDE AND THERE IS NOTHING VISIBLE ON THE BACK PANEL.

4350 RIGHT SIDE CUTAWAY

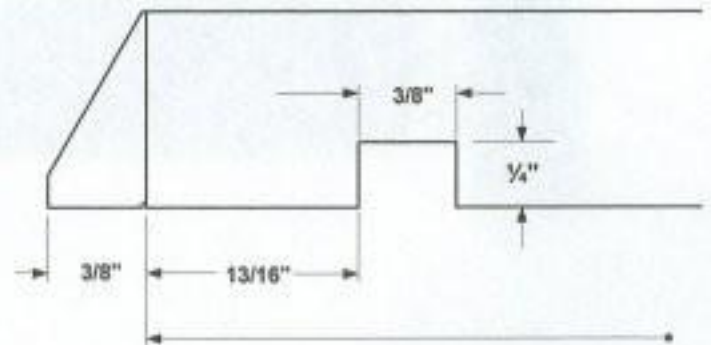
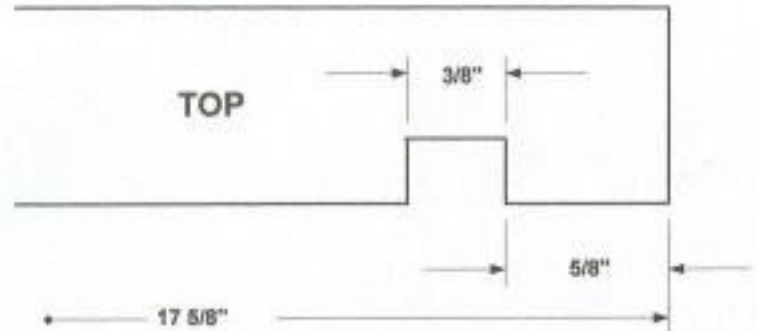
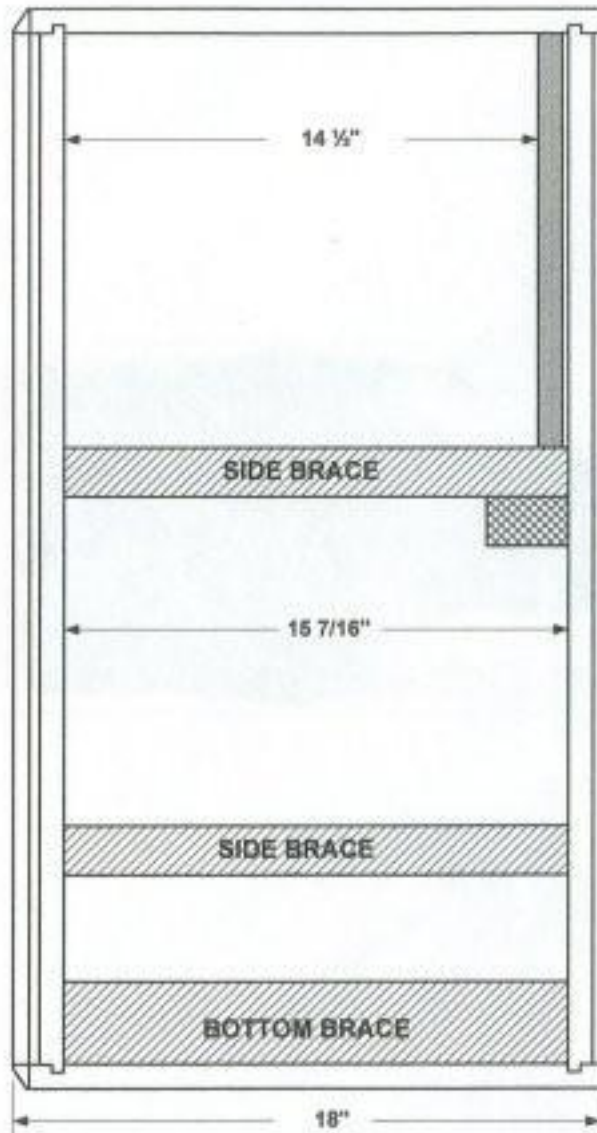

THE BAFFLE AND BACK PANEL ARE DADO MOUNTED INTO THE TOP, SIDES AND BOTTOM. DEPTH IS 1/4" AND WIDTH IS LIKELY 3/8".

4350 RIGHT SIDE CUTAWAY
LAYER #1

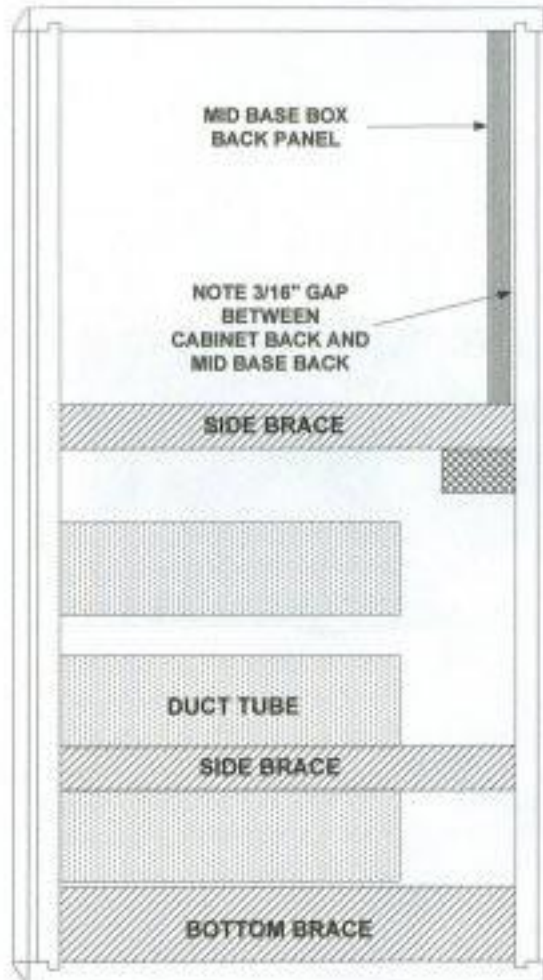

4350 RIGHT SIDE CUTAWAY
LAYER #2

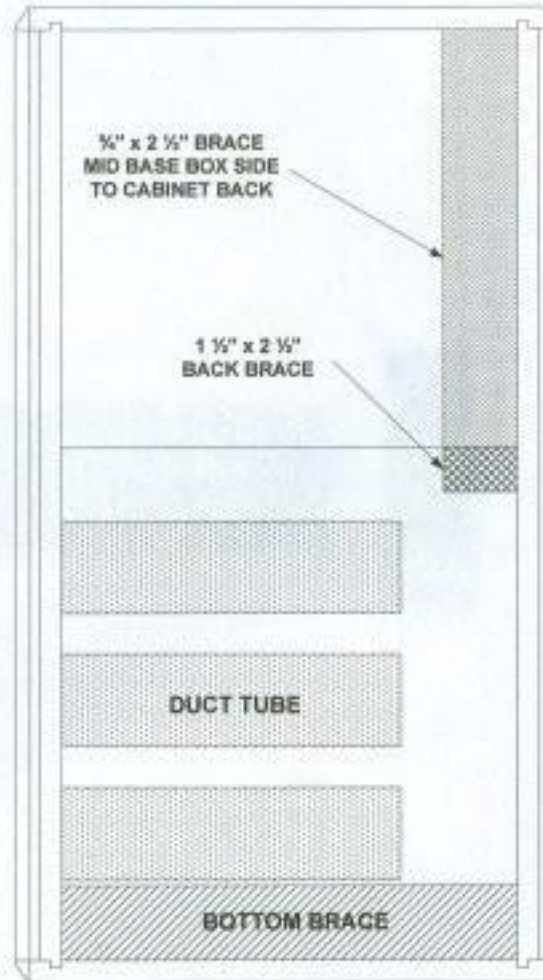

4350 TOP CUTAWAY LAYER #1

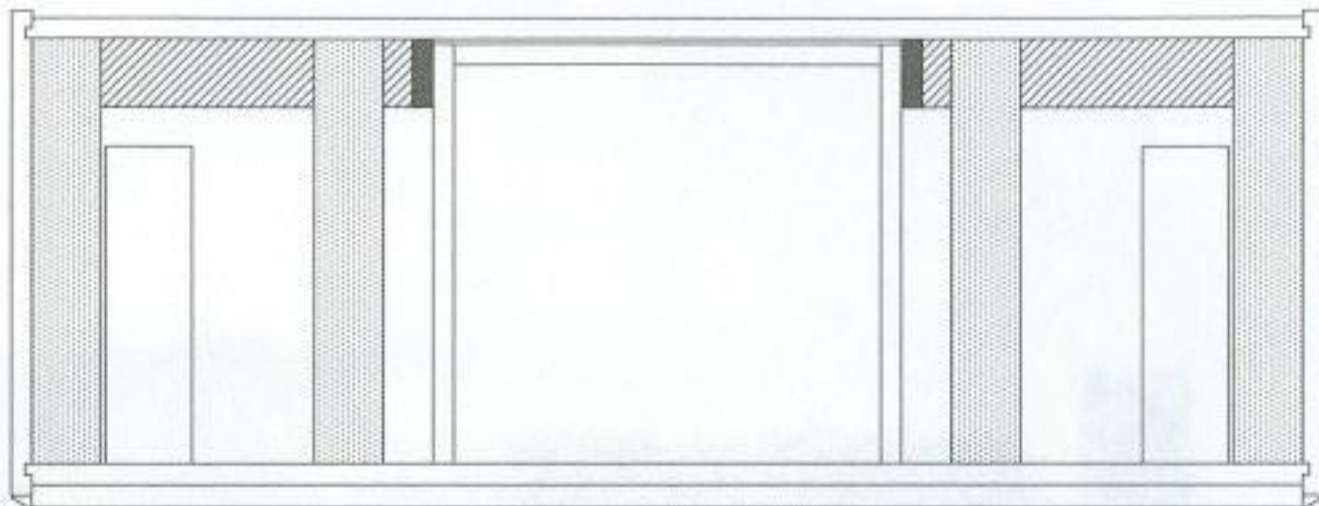

4350 TOP CUTAWAY LAYER #2



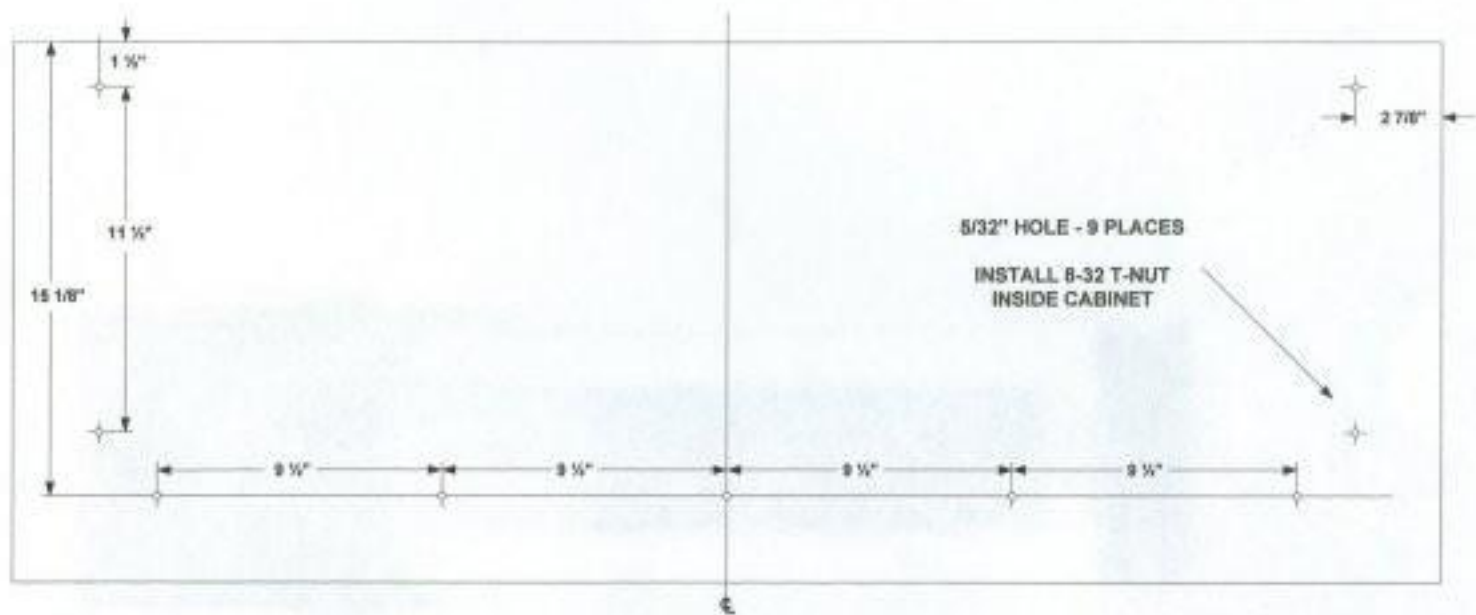

FRONT

CABINET BOTTOM VIEW

HOLE LAYOUT FOR CABINET BASE

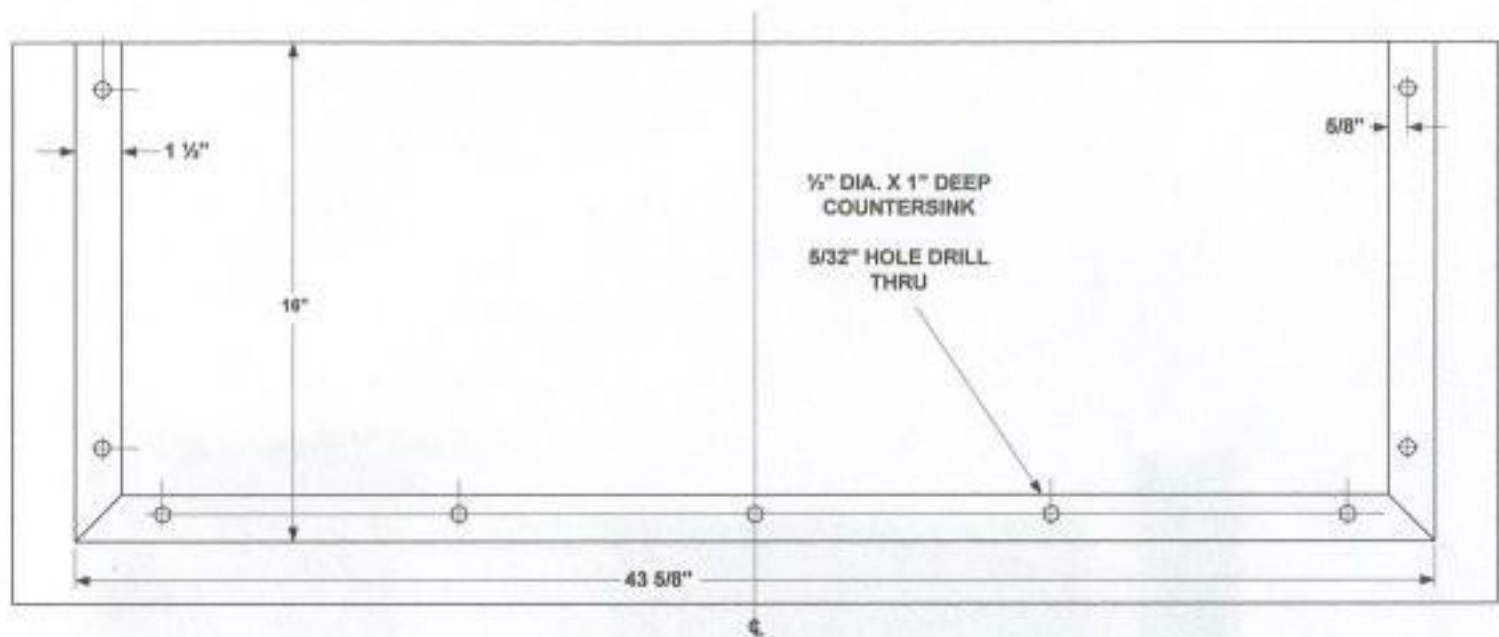

FRONT

CABINET BOTTOM VIEW
CABINET BASE DETAIL

CABINET BASE IS REMOVABLE AND IS MADE OF PINE OR FIR
AND IS PAINTED BLACK. MATERIAL IS $1 \frac{1}{2}"$ WIDE x $1 \frac{7}{8}"$ HIGH

CABINET BOTTOM VIEW
HOLE LAYOUT FOR 3107
AND INTERNAL BRACKETS

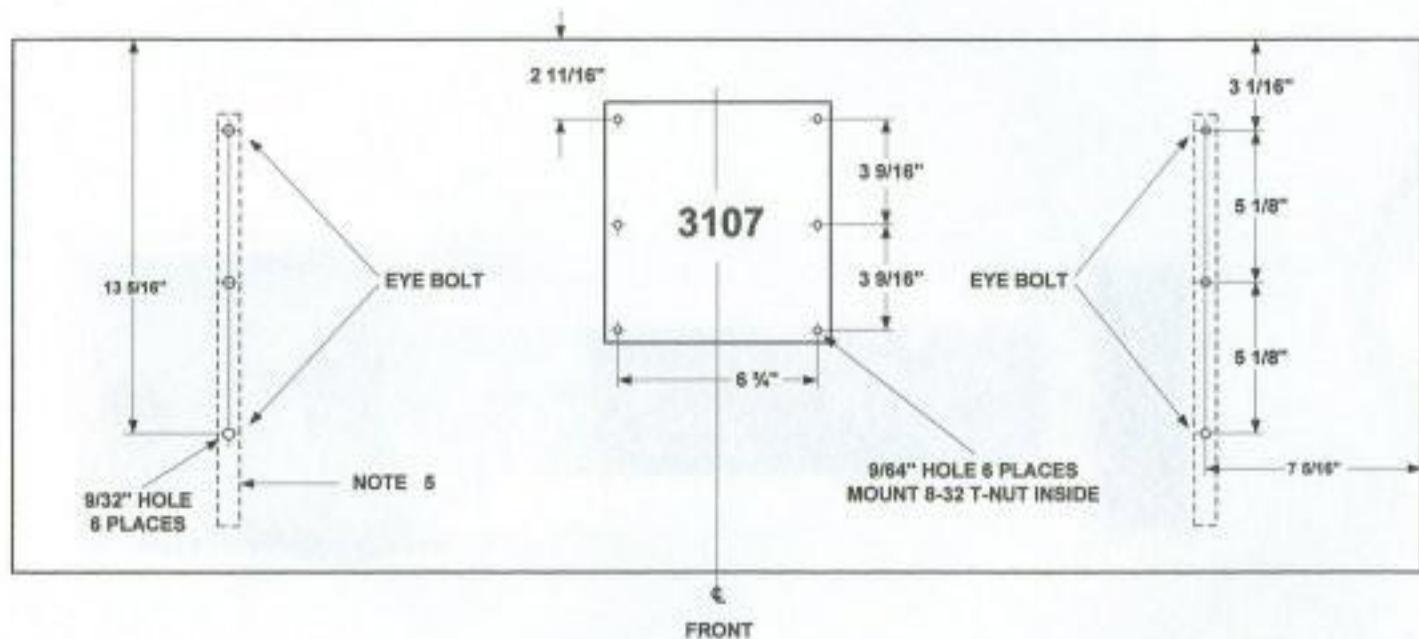

THERE ARE TWO INTERNAL STEEL L-BRACKETS THAT SUPPORT THE WEIGHT OF THE BAFFLE AND MOUNTED COMPONENTS WHEN THE CABINET IS INVERTED AND HUNG FROM CEILING CABLES.

NOTE 5

AT EACH OF THE 4 CORNER HOLES THERE ARE EYE BOLTS MOUNTED. THE EYE BOLTS ARE GALVANIZED FORGED EYE BOLTS THAT ARE SHOULDERED STYLE. SIZE IS $\frac{1}{4}$ " - 20 x 2" LONG.

L-PAD MOUNTING DETAIL

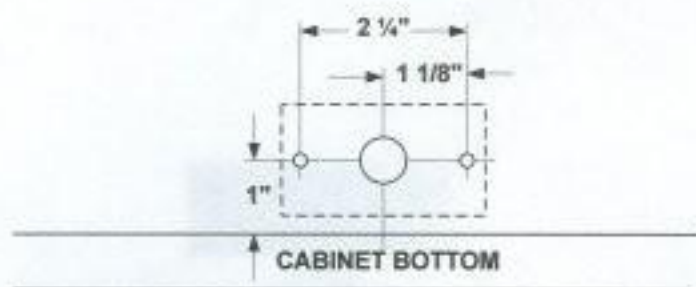

PORT AND DUCT TUBE DETAIL

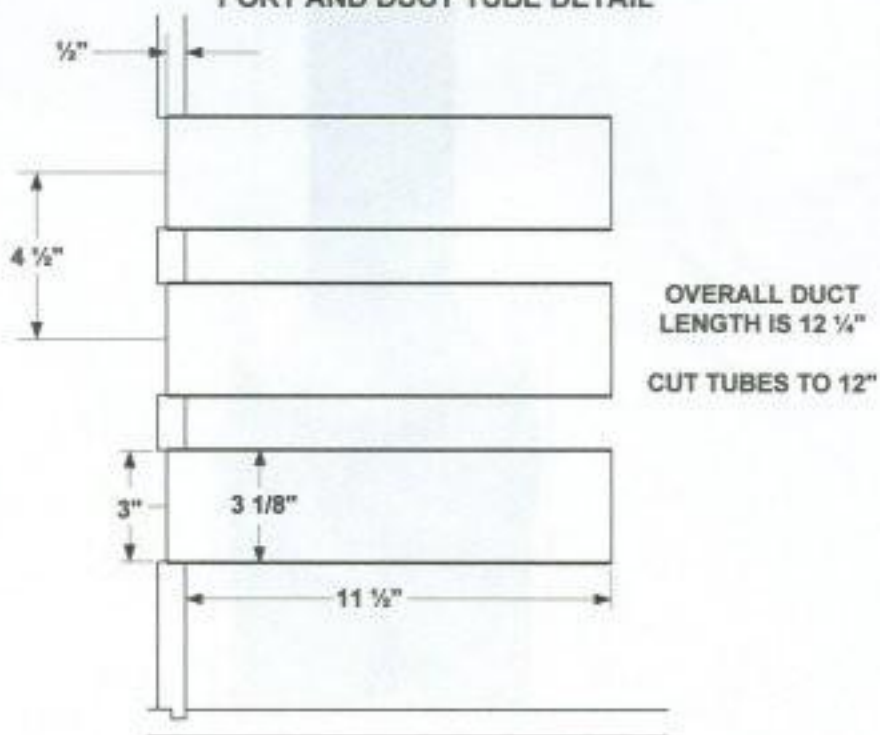

METAL SUPPORT BRACKET FOR 2311/2440

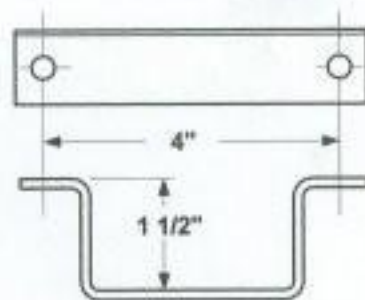
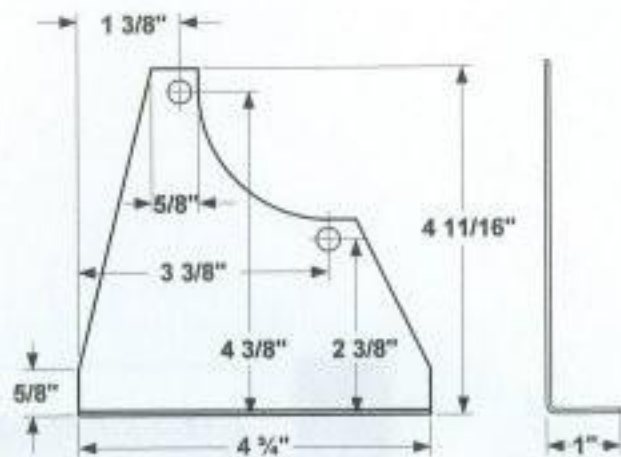
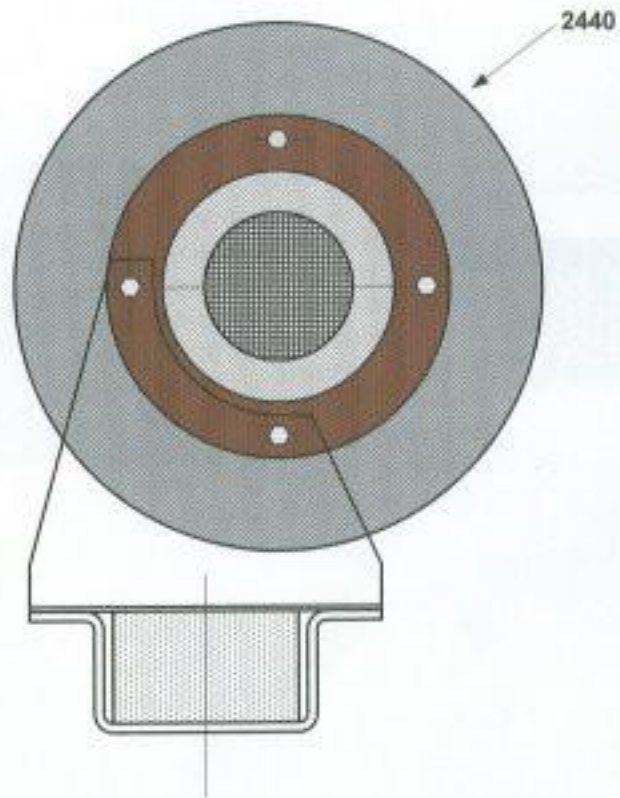

4350 BAFFLE GRILLE OVERLAY

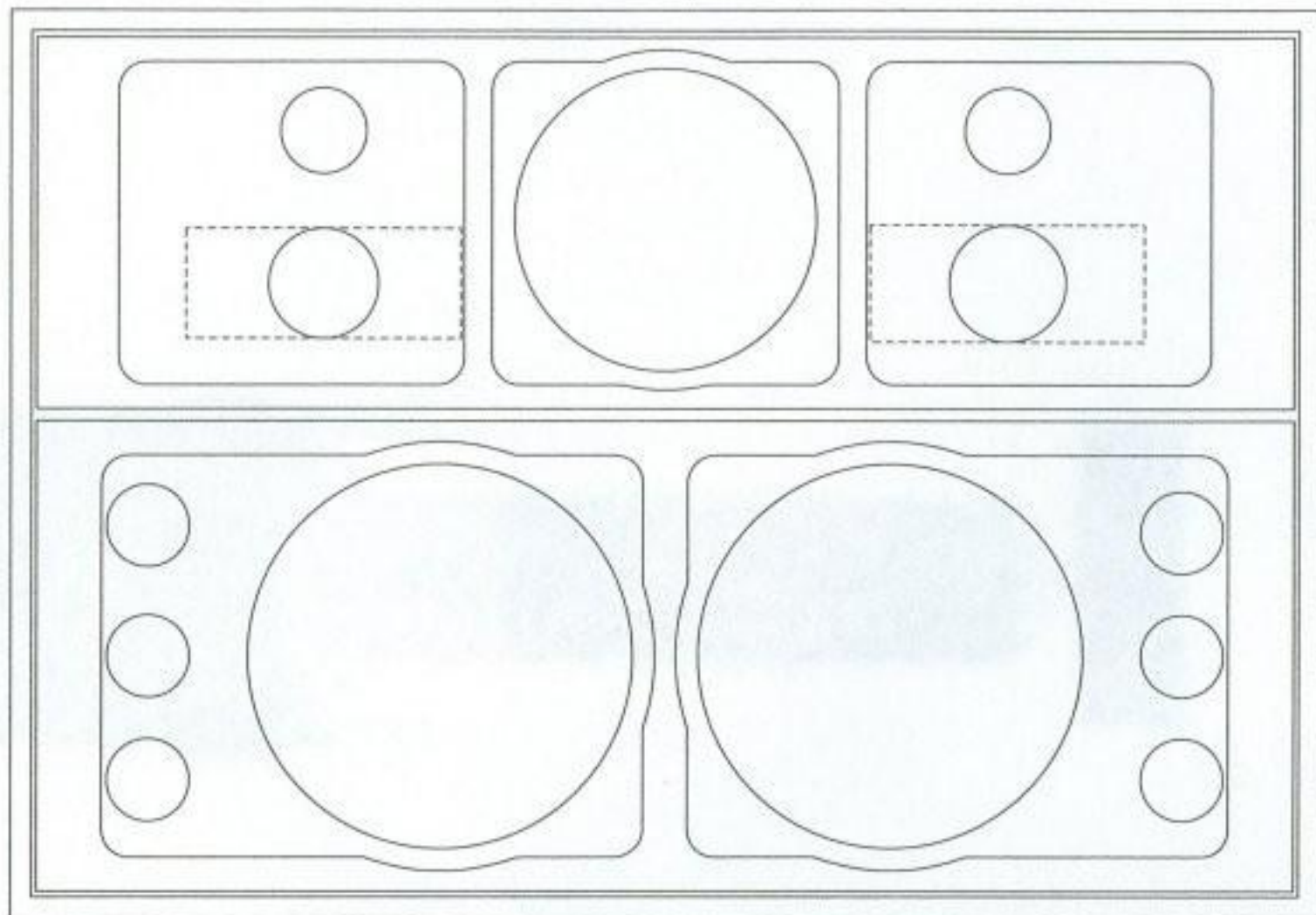

4350 LOWER GRILLE
GRILLE BASE 5/8" PARTICLE BOARD

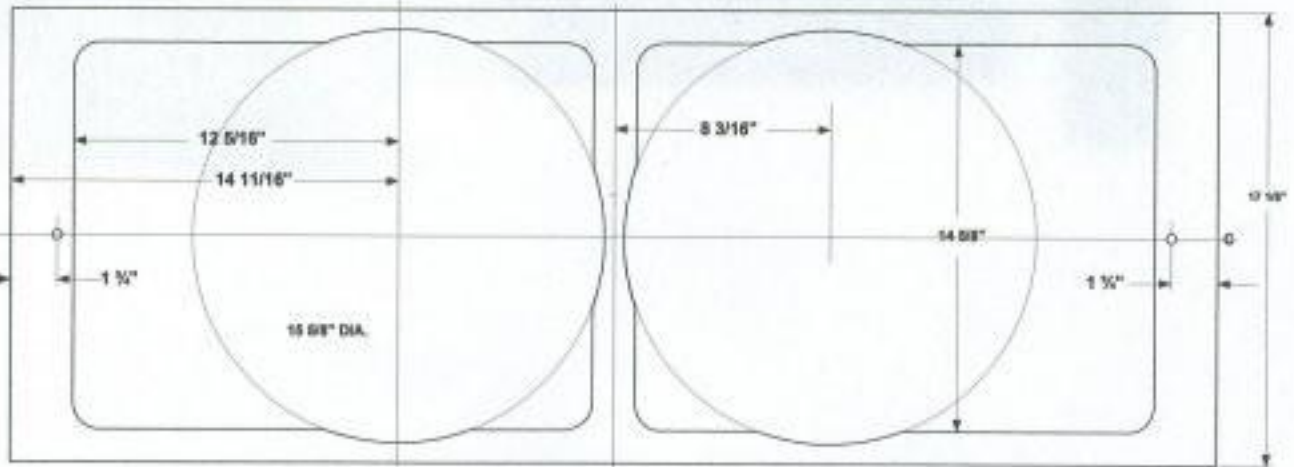
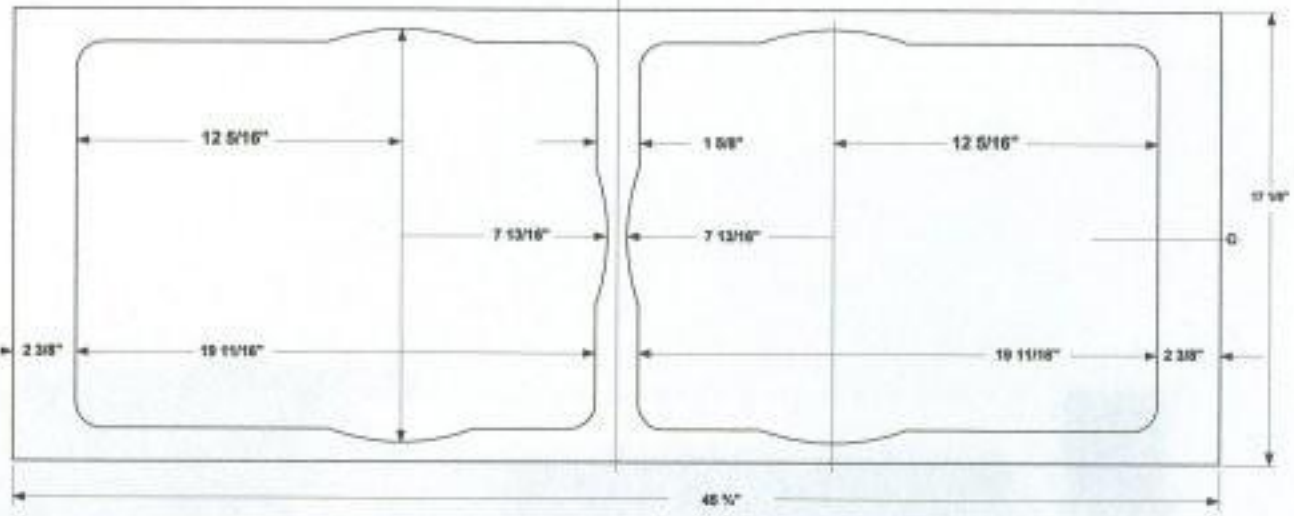

4350 UPPER GRILLE
GRILLE BASE 5/8" PARTICLE BOARD

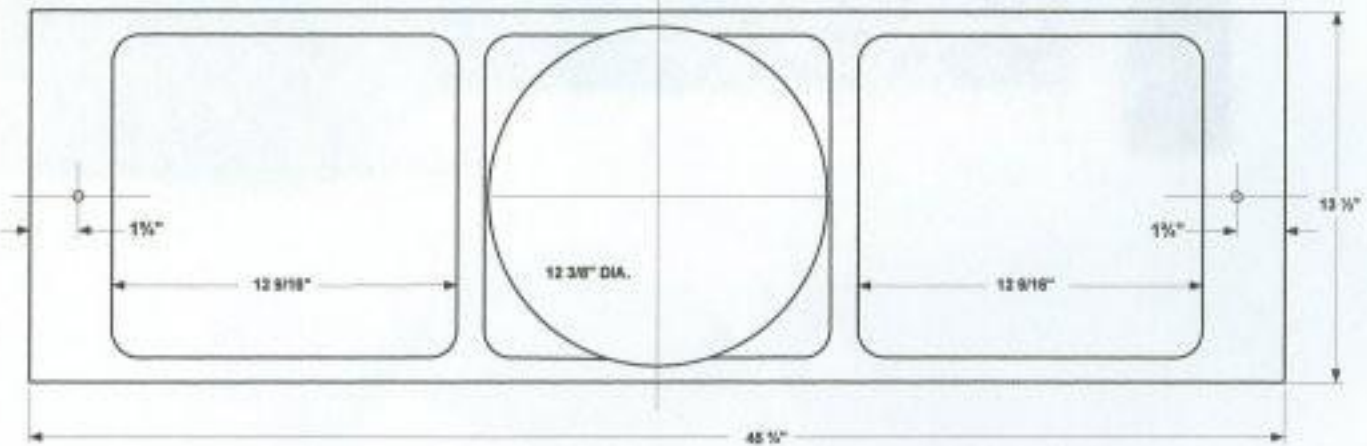
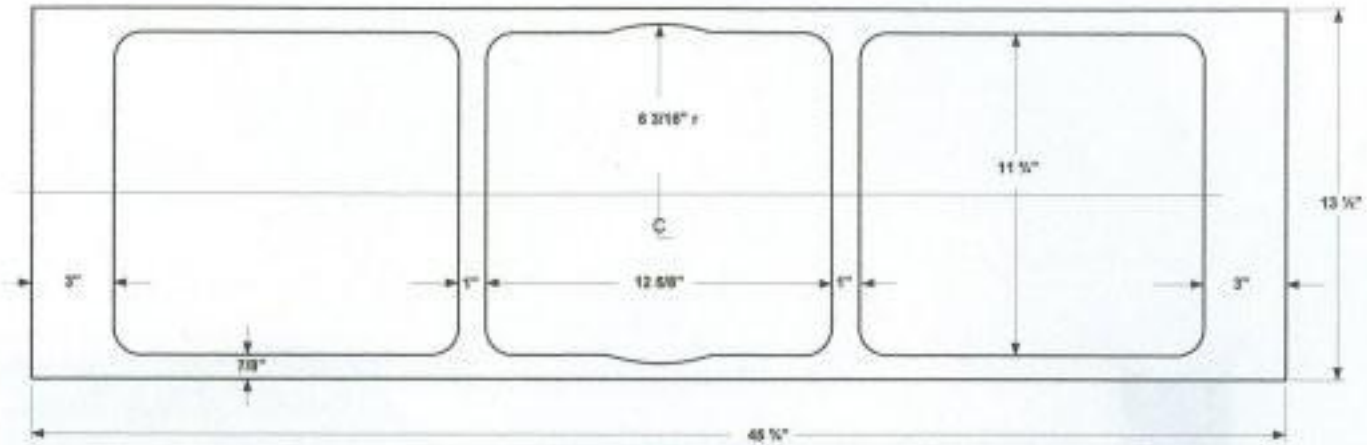

4350 LOWER GRILLE
GRILLE BASE WITH STANDOFFS MOUNTED

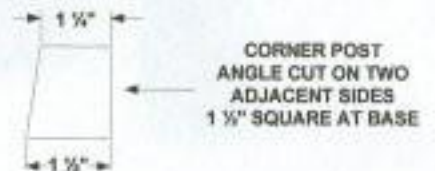
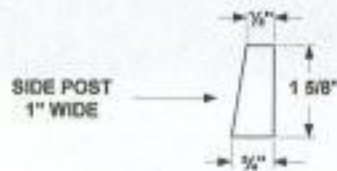
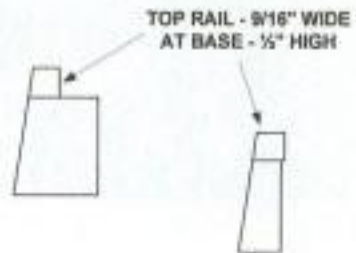
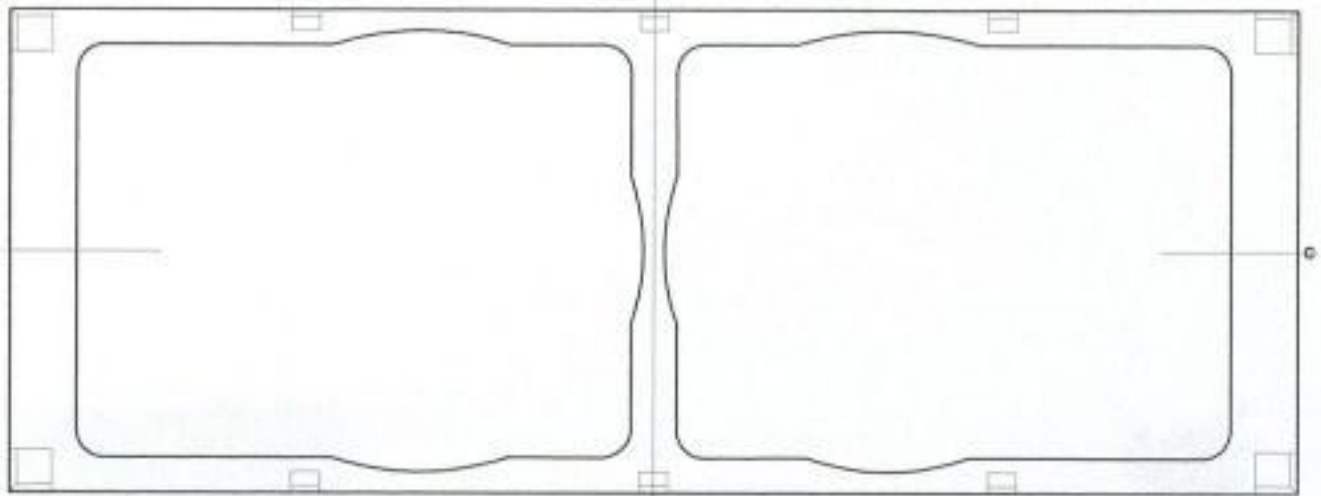

4350 LOWER GRILLE
TOP RAIL INSTALLED

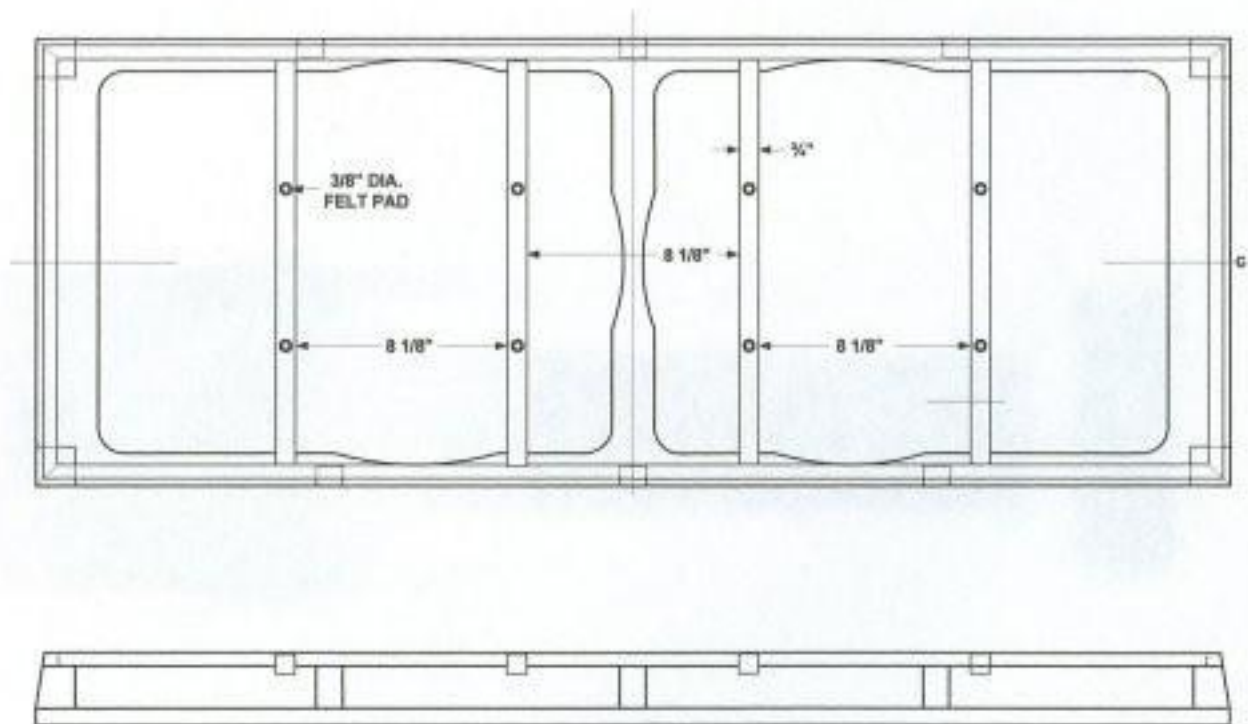

4350 UPPER GRILLE
STAND OFFS AND TOP RAIL INSTALLED

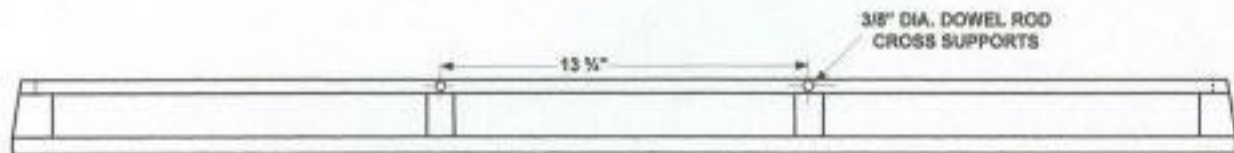
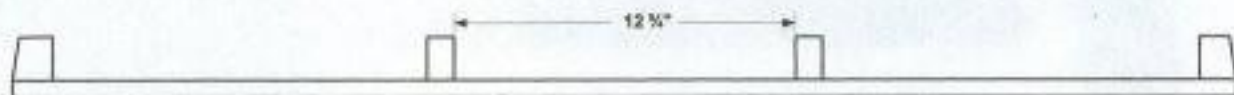
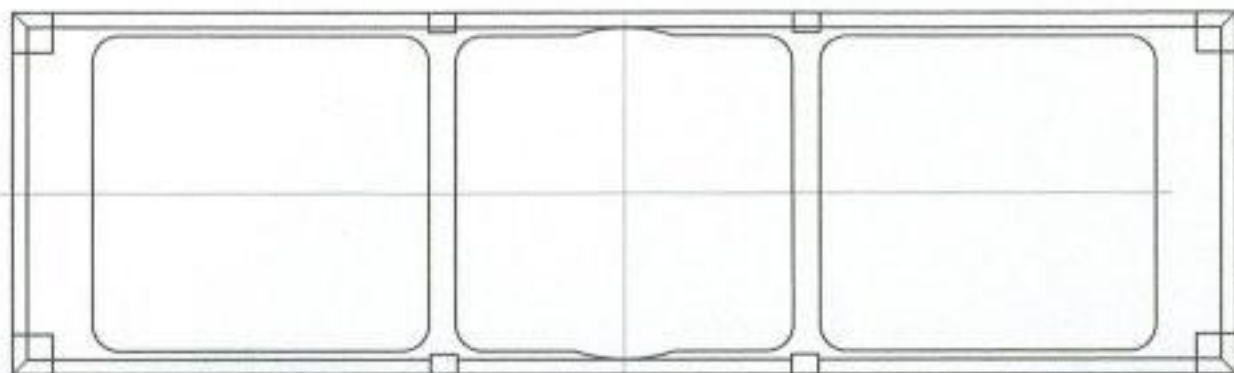

UPPER GRILLE END VIEW

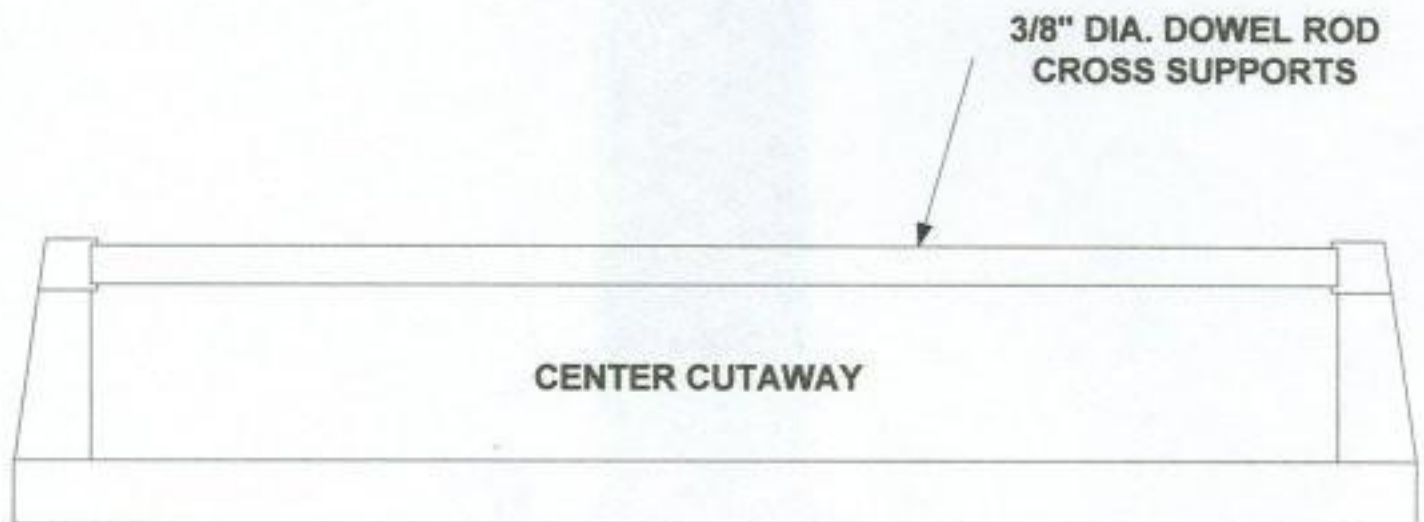
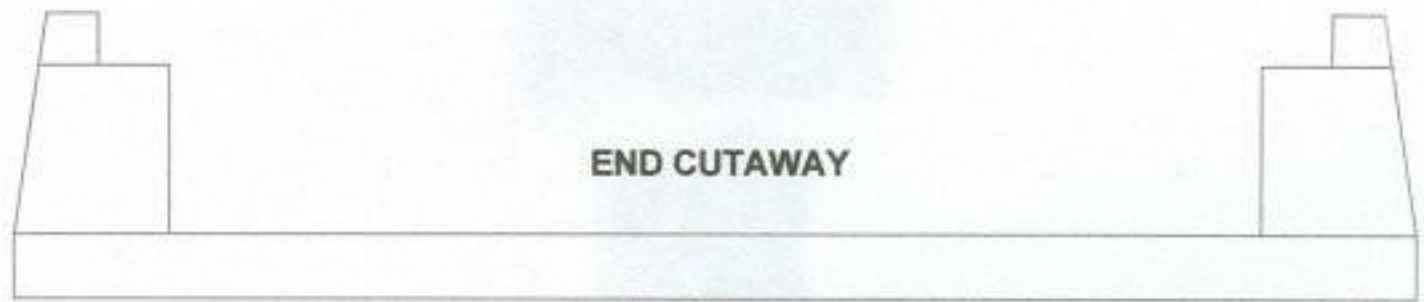

LOWER GRILLE END VIEW

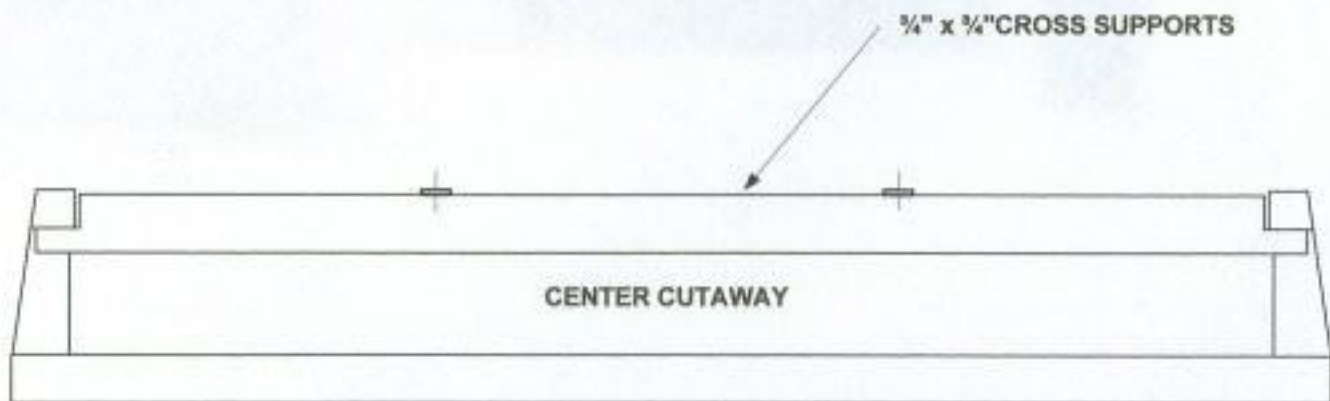
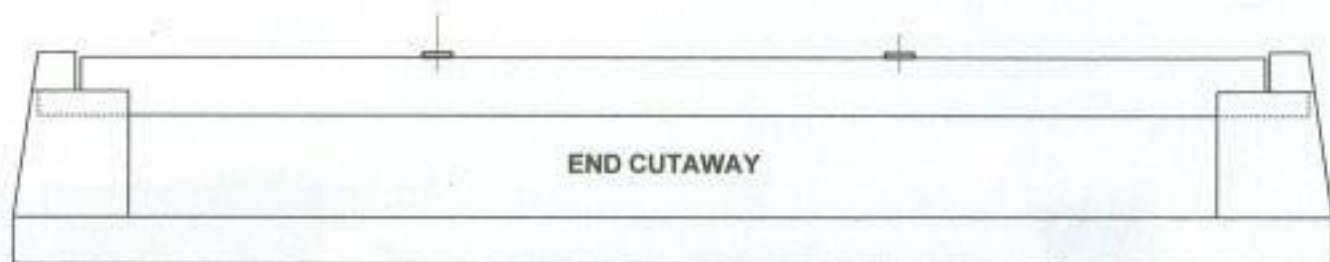

**4350 CABINET
MID-BASE BOX MOUNTING**

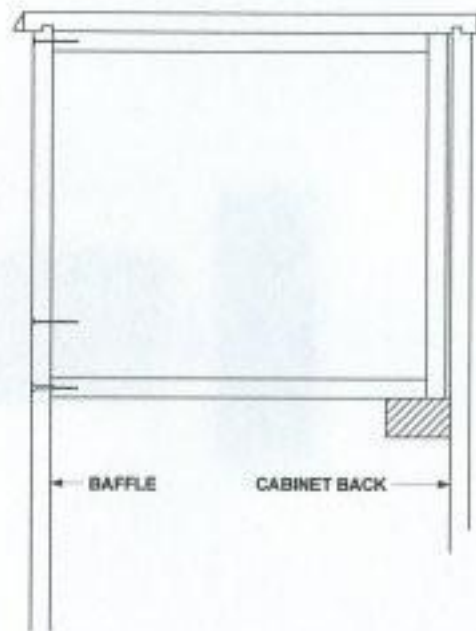
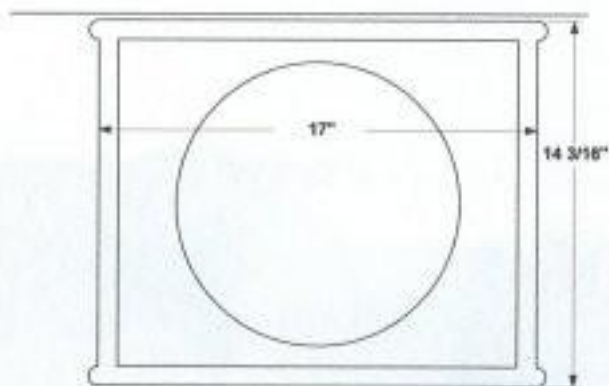

ON EARLY MODELS THE MID BASE BOX WAS MOUNTED FLUSH TO THE INSIDE FACE OF THE BAFFLE AND WAS GLUED AND SCREWED IN PLACE. SCREW HEADS ARE VISIBLE ON THE BAFFLE FRONT.

ON LATER MODELS THE SCREWS WERE DELETED AND THE BOX WAS GLUED AND NAILED THRU THE BAFFLE. THE NAIL HEADS ARE LESS OBVIOUS BUT ARE VISIBLE THRU THE PAINT.

SOME 4350B MODELS HAD THE BOX GLUED INTO A 1/4" DEEP x 3/4" WIDE DADO CUT INTO THE BAFFLE. THIS METHOD IS USED ON THE 4340, 4341, 4343, 4345 AND 4355.